



TWO-STORY PREFABRICATED STADIUM BUILDINGS

PROJECT NAME:

Floyd Hull Stadium
East & West

OWNER:

City of Jacksonville, FL

ARCHITECT:

Atkins Global

CONTRACTOR:

MBR Construction

BUILDING

AMENITIES:

Multi-Occupant
Restroom

Warm & Serve
Concession

Storage Area

Utility Chase

Serving Windows with
Hurricane Shutters

HVAC Unit

Covered Awning

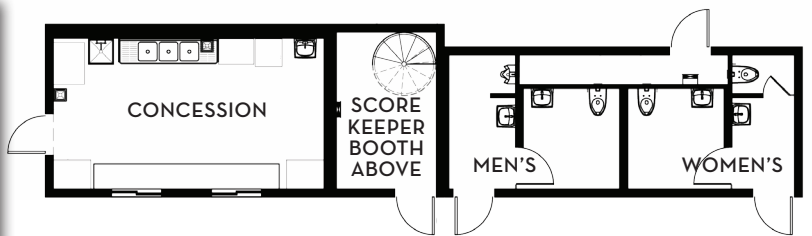

TWO-STORY LINEAR FLOOR PLAN

DESCRIPTION OF PROJECT:

This historic park renovation project required the replacement of two narrow concession facility, restroom, and score booth buildings. Funding for this project required that it be completed from plan submittal to completion of the project within 90 days. The south Florida HVHZ location required severe hurricane wind design compliance and Florida approved components. Vandal resistant component design was a neighborhood requirement to reduce future maintenance costs. This all masonry and steel construction building is designed for a useful life of 50+ years with *green design criteria*. Site installation was completed in 5 days.

QUALITY COMPONENT SELECTION

Our LEED® licensed architectural staff utilizes the largest specialized design library and proven design concepts that deliver life cycle maintenance reduction and high vandal resistance. Our 40 years of experience teaches us which components work. If we cannot find a component that lasts, we design and build our own.



WWW.PUBLICRESTROOMCOMPANY.COM | 888-888-2060

© 2014 - ALL RIGHTS RESERVED | PUBLIC RESTROOM COMPANY